

ninoSAFE Horizontal –

Superior Accessible Work Area

ninoSAFE Horizontal is an Open Laminar Flow cabinet providing a controlled environment inside the cabinet protecting the products handled from being contaminated. It has a generous work height of 995 mm and easy-to-clean one piece stainless steel or high pressure laminate table top.



Product protection

Filtered air Ambient air

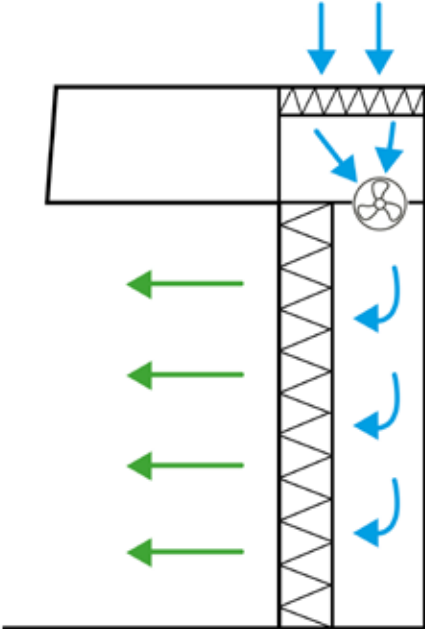

Technical Specifications

TECHNICAL SPECIFICATIONS ninoSAFE Horizontal				
Size		1200	1500	1800
Dimensions				
External dimensions excl support, WxDxH	mm	1303x900x1250	1603x900x1250	1907x900x1250
External dimensions incl support, table top at 800 mm, WxDxH	mm	1303x799x1955	1603x799x1955	1907x799x1955
Internal dimensions, WxDxH	mm	1200x600x995	1500x600x995	1800x600x995
Front opening	mm	995		
Work height, basic support stand	mm	800 or 900 (±25)		
Work height, adjustable support stand	mm	700-1050		
Work height, electrically elevated support stand	mm	750-1050		
Minimum door way	mm	910		
Weight				
Equipment	kg	225	255	285
Air velocity				
Horizontal flow	m/s	0,35 (adjustable 0,25 - 0,53)		
Deviation	±%	< 8		
Noise				
Noise level, measured according to EN12469	dB(A)	< 56	< 58	< 59
Ventilation				
Down flow rate	m ³ /h	680	840	1010
Filter technology				
Main	type	HEPA H14 EN1822, 99,999% at 0,3 µm particle size		
Prefilter	type	G4		
Light				
LED	Lux	0-2000, dimmable		
Electrical data				
Voltage frequency	V/Hz	220-240/50-60 or 110-120/50-60		
Power consumption, from	W	110	140	150

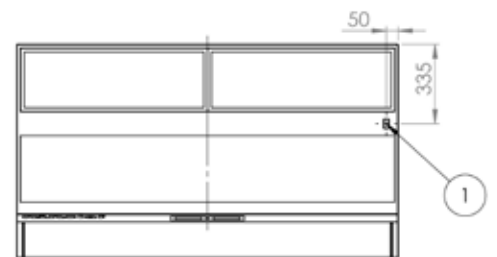
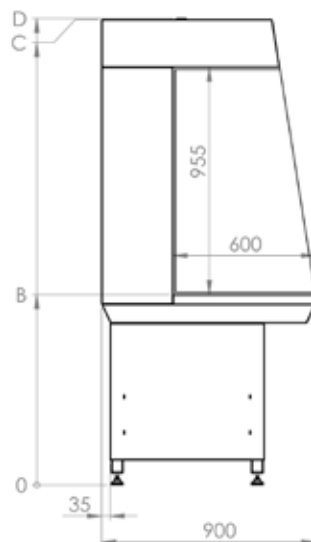

ninoSAFE Horizontal specifications						
Cabinet	A - Length	B - Work height	C - Top cabinet	D - Highest point	E - Work opening	W - Weight
NHS 900	1003 mm	750 - 1100 mm	1905-2255 mm	1910-2260 mm	938 mm	195 kilo
NHS 1200	1303 mm	750 - 1100 mm	1905-2255 mm	1910-2260 mm	1238 mm	225 kilo
NHS 1500	1603 mm	750 - 1100 mm	1905-2255 mm	1910-2260 mm	1538 mm	255 kilo
NHS 1800	1907 mm	750 - 1100 mm	1905-2255 mm	1910-2260 mm	1842 mm	285 kilo

Notes	
POS.	Description
1	Power Supply Point